

## MCM 1649

## 1 POINT MORTISE LOCK METALLIC - DEADBOLT - E

Mortise lock for metallic doors with 1 locking point with Deadbolt, especial for metal cabinets and with europrofile cylinder Serie E.



## TECHNICAL FEATURES

Lock Type	Single Point,
Operation Type	Cylinder Operated
Locking Elements	Deadbolt
Locking Type	European Profile Cylinder
Recommended Cylinder	E
Key Turns	1
Number of Keys	3
Case Dimensions (mm)	Height 94 x Depth 32.5 x Thickness 14
Backset Inc Forend (mm)	18
Forend Dimensions (mm)	Length 159 x Width 23.0 x Thickness 3
Forend Shape	Flat
Case	Steel, Galvanised
Forend	Material: Steel, Finish: Stainless Steel
Deadbolt Operation	Standard
Deadbolt Throw (mm)	13
Net Weight (kg)	0.5
Boxed Quantity	1
Industrial Packaging Quantity	30
Standard Packaging	Box

# MCM 1649

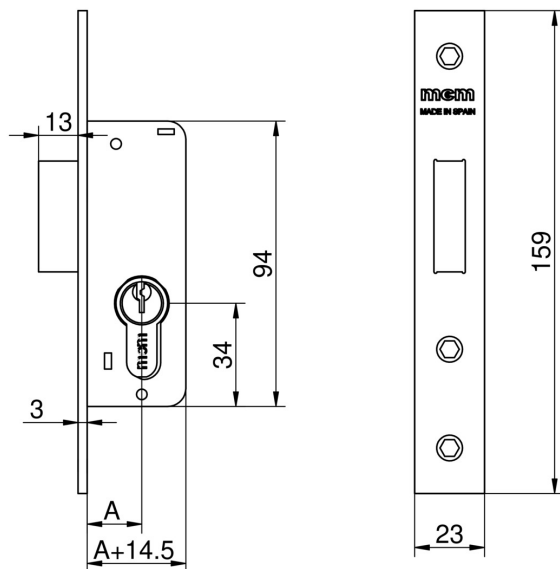

## ADDITIONAL INFORMATION

Escutcheon Included	Yes
Accessories Included	Cylinder, Escutcheon

## THE BENEFITS

- Lock especially indicated for metal cabinets.
- High resistance to corrosion thanks to the closed box made of galvanized steel.
- Full range of functions with unified box